

WAX MUSEUM CONDOS

917 CONTI STREET
NEW ORLEANS, LA

THESE PLANS AND SPECIFICATIONS HAVE BEEN PREPARED BY ME OR UNDER MY CLOSE PERSONAL SUPERVISION AND TO THE BEST OF MY KNOWLEDGE AND BELIEF THEY COMPLY WITH ALL CITY, STATE AND FEDERAL REQUIREMENTS, AND I AM NOT PROVIDING CONTRACT ADMINISTRATION.

CERTIFIED CORRECT



THIS DRAWING IS CONFIDENTIAL AND NOT BE LOANED, REPRODUCED, COPIED, EITHER WHOLLY OR IN PART, OR MADE PUBLIC IN ANY MANNER WITHOUT THE WRITTEN CONSENT OF HBSA II ARCHITECTS, A PROFESSIONAL L.L.C. ALL RIGHTS OF DESIGN OR INVENTION ARE RESERVED AND WILL REMAIN THE SOLE PROPERTY OF HBSA II ARCHITECTS A PROFESSIONAL L.L.C.

REVISION HISTORY				
	DATE	DESCRIPTION	BY	CHK
1	06/20/16	SCHEMATIC DESIGN		
2	07/14/16	DESIGN DEVELOPMENT		
3	08/19/16	FOUNDATION PERMIT		
4	09/30/16	VCC PERMIT REVIEW		

ENLARGED UNIT PLANS

PROJECT#: 1435
PHASE: PERMIT
DRAFTER: Author
CHECKER: Checker
SCALE: AS NOTED
ISSUED: 09/30/2016
SHEET#:

A114

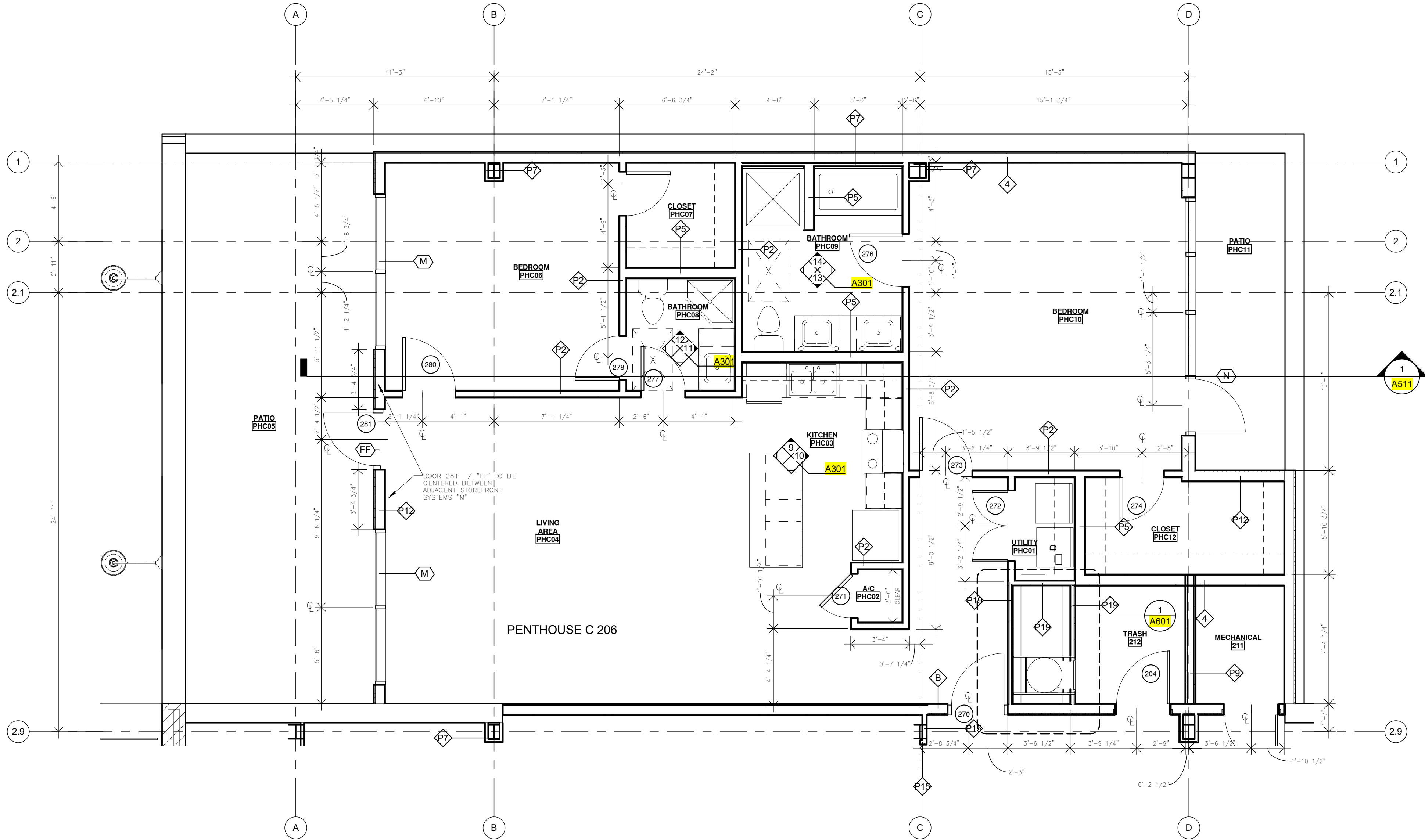

1 PENTHOUSE 206
SCALE: 1/4" = 1'-0"